

DIMENSIONS

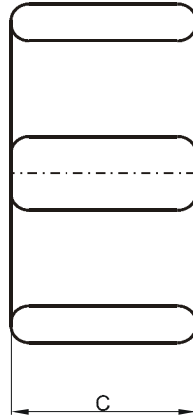
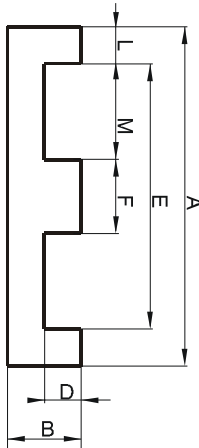

(mm)	Nominal:	Tol. min.:	Tol. max.:
A	18.0	-0.35	+ 0.35
B	4.0	-0.1	+ 0.1
C	10.0	-0.2	+ 0.2
D	2.0	-0.1	+ 0.1
E	13.7 Min.		
F	4.0	-0.1	+ 0.1
L	2.0 Ref.		
M	5.0 Ref.		
Eff. Parameters			
Ae mm ²	Amin mm ²	le mm	Ve mm ³
40.1	39.9	24.2	972

INDUCTANCE

AL value (nH/T ²)	Test conditions
1550 ± 25%	10 kHz, < 0.5 mT, 25 °C

MARKING

No marking

CORE LOSSES

P _i max	Test conditions
226 mW/cm ³ (0.22 W/set)	1000 kHz, 30 mT, 100 °C
Ref. 400 mW/cm ³ (0.39 W/set)	3000 kHz, 10 mT, 100 °C