

DIMENSIONS

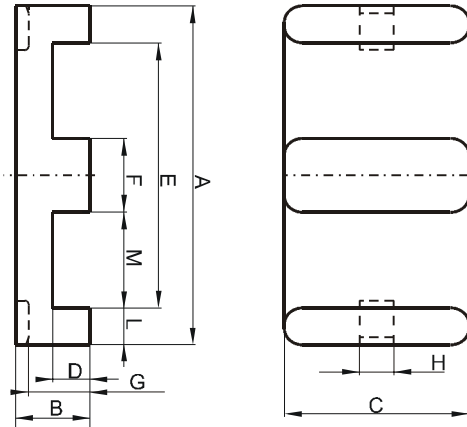

(mm)	Nominal:	Tol. min.:	Tol. max.:
A	14.0	-0.3	+ 0.3
B	3.5	-0.1	+ 0.1
C	5.0	-0.15	+ 0.15
D	1.91 Min.		
E	10.5 Min.		
F	3.0	-0.1	+ 0.1
G	2.8	-0.15	+ 0.15
H	2.5	0.0	+ 0.2
L	1.5 Ref.		
M	4.0 Ref.		
Eff. Parameters			
Ae mm²	Amin mm²	le mm	Ve mm³
12.8	11.4	20.1	257

INDUCTANCE

AL value (nH/T ²)	Test conditions
600 ± 25%	10 kHz, < 0.5 mT, 25 °C

MARKING

No marking

CORE LOSSES

P _i max	Test conditions
230 mW/cm ³ (0.059 W/set)	1000 kHz, 30 mT, 100 °C
Ref. 400 mW/cm ³ (0.103 W/set)	3000 kHz, 10 mT, 100 °C