

# ZT47313TC

## DIMENSIONS

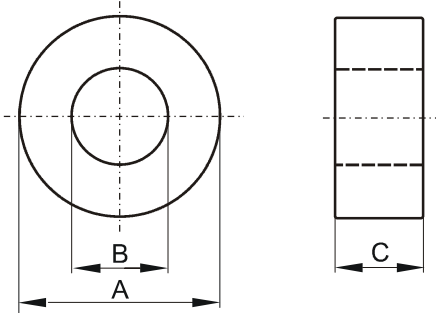

(mm)	Uncoated Nominal:	Coated Min:	Coated Max:
<b>O.D. (A)</b>	73.7	72.76	75.06
<b>I.D. (B)</b>	38.9	37.46	39.76
<b>Ht. (C)</b>	12.5	12.16	13.34
Eff. Parameters			
<b>Ae mm<sup>2</sup></b>	<b>le mm</b>	<b>Ve mm<sup>3</sup></b>	
210	165	34771	

## INDUCTANCE

AL value (nH/T <sup>2</sup> )	Test conditions
4790 ± 25%	10 kHz, 0.5 mT (For N=5, use 2.58 mA), 25°C

## CORE LOSSES

P <sub>i</sub> max	Production lot limit Max avg	Test conditions
< 30.7 W (< 880 mW/cm <sup>3</sup> )	< 28.0 W (< 800 mW/cm <sup>3</sup> )	100 kHz, 200 mT, 25 °C
< 30.0 W (< 858 mW/cm <sup>3</sup> )	< 27.2 W (< 780 mW/cm <sup>3</sup> )	100 kHz, 200 mT, 100 °C

## COATING

Epoxy rated for 200°C continuous operation  
Voltage breakdown rating 2000V Min Wire-to-Wire

## NOTE

Spec. modifications	Previous	Revised
2013-05-20		Issued