

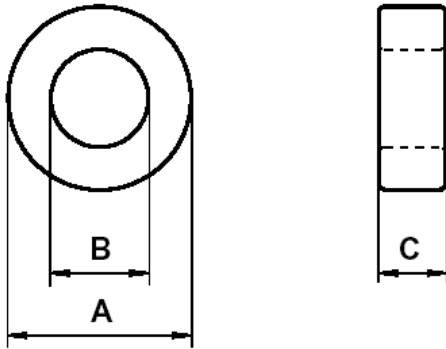

Specification for:
ZR44015TC

110 Delta Drive
Pittsburgh, PA 15238
Phone: 412/696-1333
Fax: 412/696-0333
Email: magnetics@spang.com

DIMENSIONS



(mm)	Uncoated Nominal:	Coated Min:	Coated Max:
O.D. (A)	41.8	40.95	43.15
I.D. (B)	26.2	25.15	26.75
Ht. (C)	18.0	17.80	19.20

Eff. Parameters		
A_e mm ²	l_e mm	V_e mm ³
138	103	14205

INDUCTANCE

AL value (nH/T ²)	Test conditions
3867 ± 25%	10 kHz, 0.5 mT (For N = 5, use 2.016 mA), 25°C

CORE LOSSES

P_L max	Production lot limit Max avg	Test conditions
1.56 mW (110 mW/cm ³)	1.42 mW (100 mW/cm ³)	100 kHz, 100 mT, 100°C
10.15 W (715 mW/cm ³)	9.23 W (650 mW/cm ³)	100 kHz, 200 mT, 100°C

COATING

Epoxy rated for 200°C continuous operation
Voltage breakdown rating 2000 V Min Wire-to-Wire.