

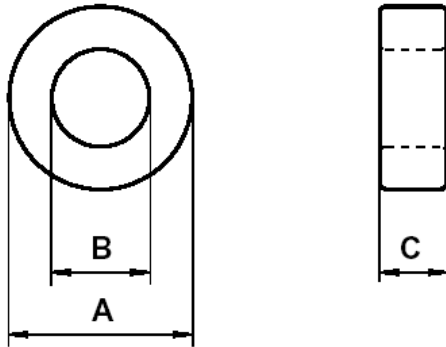

Specification for:
ZR42507TC

110 Delta Drive
Pittsburgh, PA 15238
Phone: 412/696-1333
Fax: 412/696-0333
Email:magnetics@spang.com

DIMENSIONS



(mm)	Uncoated Nominal:	Coated Min:	Coated Max:
O.D. (A)	25.34	24.89	26.29
I.D. (B)	15.45	14.6	15.8
Ht. (C)	7.92	8.08	8.56

Eff. Parameters		
A _e mm ²	l _e mm	V _e mm ³
39	61.5	2361

INDUCTANCE

AL value (nH/T ²)	Test conditions
1800 ± 25%	10 kHz, 0.5 mT (For N = 5, use 1.25 mA), 25°C

CORE LOSSES

P _L max	Production lot limit Max avg	Test conditions
260 mW (110 mW/cm ³)	236 mW (100 mW/cm ³)	100 kHz, 100 mT, 100°C
1688 mW (715 mW/cm ³)	1535 mW (650 mW/cm ³)	100 kHz, 200 mT, 100°C

COATING

Epoxy rated for 200°C continuous operation.
Voltage breakdown rating 2000 V _{DC} Min Wire-to-Wire.

NOTE

Spec. modifications	Previous	Revised
2008.01.10	Nom OD = 25.4 Nom ID = 15.5 Losses: General R material Breakdown voltage > 1,000 V	Nom OD = 25.34 Nom ID = 15.45 Losses: Detail as indicated Breakdown voltage > 2,000 V _{DC}