

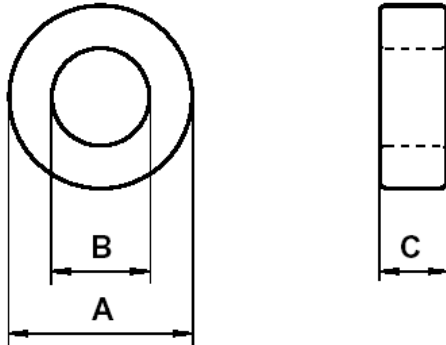

Specification for:  
**ZP47325TC**

110 Delta Drive  
Pittsburgh, PA 15238  
Phone: 412/696-1333  
Fax: 412/696-0333  
Email:magnetics@spang.com

**DIMENSIONS**



(mm)	Uncoated Nominal:	Coated Min:	Coated Max:
O.D. (A)	73.7	72.76	75.06
I.D. (B)	38.9	37.46	39.76
Ht. (C)	25.2	24.61	26.29

Eff. Parameters		
A <sub>e</sub> mm <sup>2</sup>	l <sub>e</sub> mm	V <sub>e</sub> mm <sup>3</sup>
423	165	70099

**INDUCTANCE**

AL value (nH/T <sup>2</sup> )	Test conditions
8051 ± 25%	10kHz, 0.5 mT (For N = 3, use 5.17 mA), 25°C

**CORE LOSSES**

P <sub>L</sub> max	Production lot limit Max avg	Test conditions
10.87 mW (155 mW/cm <sup>3</sup> )	9.88 W (141 mW/cm <sup>3</sup> )	100 kHz, 100 mT, 100°C

**COATING**

Epoxy rated for 200°C continuous operation.
Voltage breakdown rating 2,000 V <sub>DC</sub> Min Wire-to-Wire.

**NOTE**

Spec. Modifications	Previous	Revised
2007.08.03	Bare Nom Ht = 25.4 Losses: General P Material Breakdown voltage > 1,000 V	Bare Nom Ht = 25.4 Losses: Detail as indicated Breakdown voltage > 2,000 V <sub>DC</sub>