

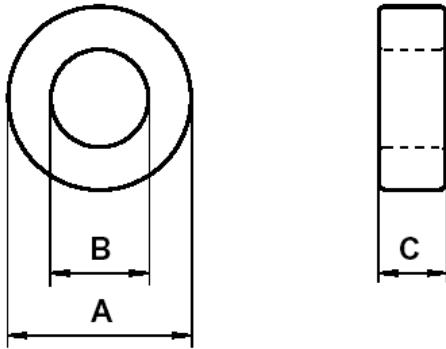

Specification for:  
**ZP44932TC**

110 Delta Drive  
Pittsburgh, PA 15238  
Phone: 412/696-1333  
Fax: 412/696-0333  
Email: [magnetics@spang.com](mailto:magnetics@spang.com)

**DIMENSIONS**



(mm)	Uncoated Nominal:	Coated Min:	Coated Max:
O.D. (A)	49.1	48.48	50.22
I.D. (B)	33.8	32.69	34.41
Ht. (C)	31.3	30.96	32.64

Eff. Parameters		
$A_e$ mm <sup>2</sup>	$l_e$ mm	$V_e$ mm <sup>3</sup>
237	127	30116

**INDUCTANCE**

AL value (nH/T <sup>2</sup> )	Test conditions
5900 ± 25%	10 kHz, 0.5 mT (For N = 5, use 2.36 mA), 25°C

**CORE LOSSES**

$P_L$ max	Production lot limit Max avg	Test conditions
3.97 W (131 mW/cm <sup>3</sup> )	3.61 W (120 mW/cm <sup>3</sup> )	100 kHz, 100 mT, 100°C

**COATING**

Epoxy rated for 200°C continuous operation.
Voltage breakdown rating 2000 V <sub>DC</sub> min Wire-to-Wire.

**NOTE**

Spec. Modifications	Previous	Revised
2007.05.30	Bare Nom Ht = 31.8  Losses: General P material Breakdown voltage > 1,000 V	Bare Nom Ht = 31.3  Losses : Detail as indicated Breakdown voltage > 2,000 V <sub>DC</sub>