

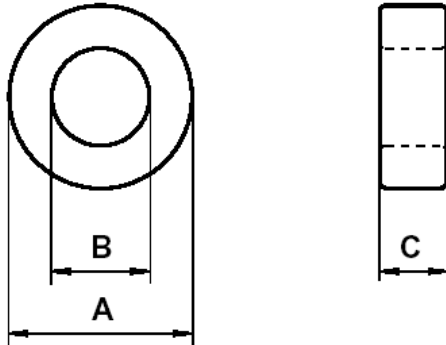

Specification for:
ZP43615TC

110 Delta Drive
Pittsburgh, PA 15238
Phone: 412/696-1333
Fax: 412/696-0333
Email:magnetics@spang.com

DIMENSIONS



(mm)	Uncoated Nominal:	Coated Min:	Coated Max:
O.D. (A)	36	35.35	37.15
I.D. (B)	23	22.05	23.45
Ht. (C)	14.6	14.4	15.6

Eff. Parameters		
A _e mm ²	l _e mm	V _e mm ³
93.3	89.6	8366

INDUCTANCE

AL value (nH/T ²)	Test conditions
3366 ± 25%	10 kHz, 0.5 mT (For N = 5, use 1.7 mA), 25°C

CORE LOSSES

P _L max	Production lot limit Max avg	Test conditions
1030 mW (123 mW/cm ³)	937 mW (112 mW/cm ³)	100 kHz, 100 mT, 100°C
-	-	-

COATING

Epoxy rated for 200°C continuous operation.
Voltage breakdown rating 2000 V Min Wire-to-Wire.

NOTE

Spec. Modifications	Previous	Revised
2005.04.25	Bare Nom Ht = 15 OD Max = 36.89 ID Min = 22.12 Ht Max = 15.63 Losses: General P Material Breakdown voltage > 1,000 V	Bare Nom Ht = 14.6 OD Max = 37.15 ID Min = 22.05 Ht Max = 15.6 Losses: Detail as indicated Breakdown voltage > 2,000 V