

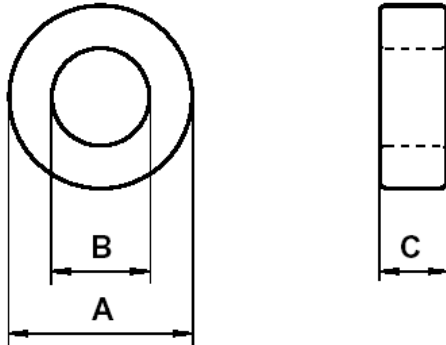

Specification for:
ZP41809TC

110 Delta Drive
Pittsburgh, PA 15238
Phone: 412/696-1333
Fax: 412/696-0333
Email:magnetics@spang.com

DIMENSIONS



(mm)	Uncoated Nominal:	Coated Min:	Coated Max:
O.D. (A)	18.40	18.09	19.21
I.D. (B)	9.75	8.99	10.01
Ht. (C)	10.30	10.20	10.90

Eff. Parameters		
A _e mm ²	l _e mm	V _e mm ³
43.1	41.4	1783

INDUCTANCE

AL value (nH/T ²)	Test conditions
3050 ± 25%	10 kHz, 0.5 mT (For N = 5, use 0.83 mA), 25°C

CORE LOSSES

P _L max	Production lot limit Max avg	Test conditions
220 mW (123 mW/cm ³)	200 mW (112 mW/cm ³)	100 kHz, 100 mT, 100°C

COATING

Epoxy rated for 200°C continuous operation.
Voltage breakdown rating 1500 V _{DC} Min Wire-to-Wire.

NOTE

Spec. Modifications	Previous	Revised
2007.09.07	Losses: General P material Breakdown voltage > 1,000 V	Losses: Detail as indicated Breakdown voltage > 1,500 V _{DC}