

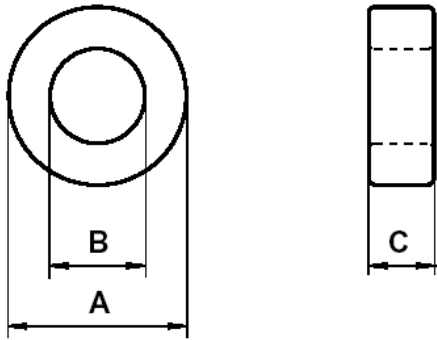

Specification for:
ZJ46013TC

110 Delta Drive
Pittsburgh, PA 15238
Phone: 412/696-1333
Fax: 412/696-0333
Email:magnetics@spang.com

DIMENSIONS



| (mm) | Uncoated Nominal: | Coated Min: | Coated Max: |
|----------|-------------------|-------------|-------------|
| O.D. (A) | 60.96 | 60.19 | 62.23 |
| I.D. (B) | 41.78 | 40.51 | 42.55 |
| Ht. (C) | 12.55 | 12.56 | 13.34 |

| Eff. Parameters | | |
|-----------------------|----------|-----------------------|
| A_e mm ² | l_e mm | V_e mm ³ |
| 118.9 | 157.6 | 18745 |

INDUCTANCE

| A_L value (nH/T ²) | Test conditions | |
|----------------------------------|-----------------|--------------------------------------|
| 4800 ± 20% | 10 kHz | 0.5 mT (For N = 1, use 7.3 mA), 25°C |
| ≥ 0.9 x A_L @ 10 kHz | 200 kHz | |

ELECTRICAL LOSSES

| $\tan \delta / \mu_i$ | Test conditions |
|-----------------------|-----------------------|
| ≤ 20·10 ⁻⁶ | 100 kHz, 0.5 mT, 25°C |

COATING

| |
|---|
| Epoxy rated for 200°C continuous operation. |
| Voltage breakdown rating 2000 V _{DC} min Wire-to-Wire. |

NOTE

| Spec. Modifications | Previous | Revised |
|---------------------|--|---|
| 2009.06.11 | Breakdown voltage > 1,000 V LF: General J Material A_L value up to 200 kHz | Breakdown voltage > 2000 V _{DC} LF: Detail as indicated A_L at 200 kHz ≥ 0.9 x A_L at 10 kHz |