

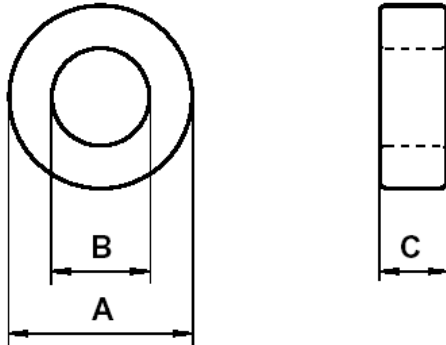

Specification for:
ZF-43806-TC

111 Zeta Drive
Pittsburgh, PA 15238
Phone: 412/696-1333
Fax: 412/696-0333
Email:magnetics@spang.com

DIMENSIONS



(mm)	Uncoated Nominal:	Coated Min:	Coated Max:
O.D. (A)	38.1	37.45	39.25
I.D. (B)	19.0	17.9	19.55
Ht. (C)	6.35	6.11	6.91

Eff. Parameters		
A _e mm ²	l _e mm	V _e mm ³
58.3	82.9	4826

INDUCTANCE

AL value (nH/T ²)	Test conditions
2640 ± 20%	10 kHz, 0.5 mT (For N = 5, use 1.3 mA), 25°C

CORE LOSSES

P _L max	Production lot limit Max avg	Test conditions
1.06 W (220 mW/cm ³)	0.97 W (200 mW/cm ³)	25 kHz, 200 mT, 100°C
-	-	-

COATING

Epoxy rated for 200°C continuous operation.
Voltage breakdown rating 2000 V Min Wire-to-Wire.

NOTE

Spec. Modifications	Previous	Revised
2005.06.07		