

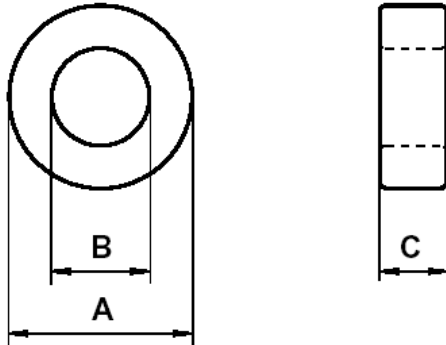

Specification for:  
**ZF42908TC**

110 Delta Drive  
Pittsburgh, PA 15238  
Phone: 412/696-1333  
Fax: 412/696-0333  
Email:magnetics@spang.com

**DIMENSIONS**



(mm)	Uncoated Nominal:	Coated Min:	Coated Max:
O.D. (A)	29	28.6	29.9
I.D. (B)	19	18.11	19.39
Ht. (C)	7.3	7.34	8.06

Eff. Parameters		
A <sub>e</sub> mm <sup>2</sup>	l <sub>e</sub> mm	V <sub>e</sub> mm <sup>3</sup>
36	73.2	2632

**INDUCTANCE**

AL value (nH/T <sup>2</sup> )	Test conditions
1902 ± 20%	10 kHz, 0.5 mT (For N = 5, use 1.1 mA), 25°C

**CORE LOSSES**

P <sub>L</sub> max	Production lot limit Max avg	Test conditions
579 mW (220 mW/cm <sup>3</sup> )	526 mW (200 mW/cm <sup>3</sup> )	25 kHz, 200 mT, 100°C

**COATING**

Epoxy rated for 200°C continuous operation.
Voltage breakdown rating 2000 V <sub>DC</sub> Min Wire-to-Wire.

**NOTE**

Spec. Modifications	Previous	Revised
2006.06.30	Bare Nom Ht = 7.5 Losses: General F material Breakdown voltage > 1,000 V	Bare Nom Ht = 7.3 Losses: Detail as indicated Breakdown voltage > 2,000 V <sub>DC</sub>