

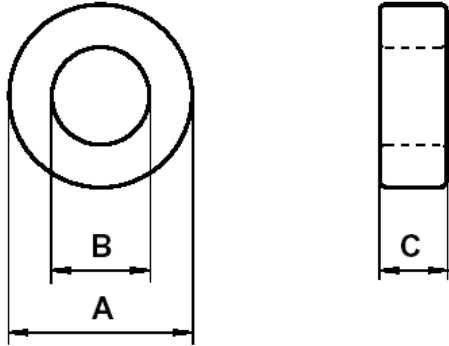

Specification for:  
**ZF40907TC**

110 Delta Drive  
 Pittsburgh, PA 15238  
 Phone: 412/696-1333  
 Fax: 412/696-0333  
 Email: [magnetics@spang.com](mailto:magnetics@spang.com)

**DIMENSIONS**



(mm)	Uncoated Nominal:	Coated Min:	Coated Max:
O.D. (A)	9.53	9.39	10.17
I.D. (B)	5.59	4.95	5.73
Ht. (C)	7.11	7.06	7.66

Eff. Parameters		
A <sub>e</sub> mm <sup>2</sup>	l <sub>e</sub> mm	V <sub>e</sub> mm <sup>3</sup>
13.7	22.7	310

**INDUCTANCE**

AL value (nH/T <sup>2</sup> )	Test conditions
2260± 25%	10 kHz, 0.5 mT (For N = 5, use 0.42 mA), 25°C

**CORE LOSSES**

P <sub>L</sub> max	Production lot limit Max avg	Test conditions
68.2 mW (220 mW/cm <sup>3</sup> )	62 mW (200 mW/cm <sup>3</sup> )	25 kHz, 200 mT, 100°C

**COATING**

Epoxy rated for 200°C continuous operation.
Voltage breakdown rating 1500 V Min Wire-to-Wire.

**NOTE**

Spec. Modifications	Previous	Revised