

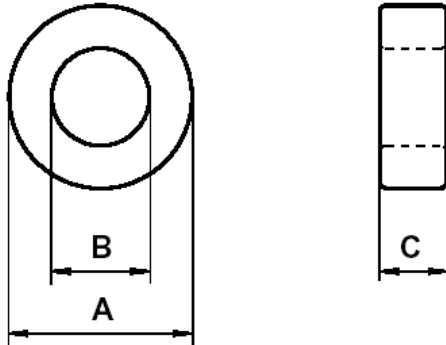

Specification for:
YR41005TC

110 Delta Drive
Pittsburgh, PA 15238
Phone: 412/696-1333
Fax: 412/696-0333
Email:magnetics@spang.com

DIMENSIONS



(mm)	Uncoated Nominal:	Coated Min:	Coated Max:
O.D. (A)	9.53	9.2	9.86
I.D. (B)	4.75	4.42	5.08
Ht. (C)	4.78	4.58	4.98

Eff. Parameters		
A _e mm ²	l _e mm	V _e mm ³
10.9	20.7	227

INDUCTANCE

AL value (nH/T ²)	Test conditions
1510 ± 25%	10 kHz, 0.5 mT (For N = 5, use 0.4 mA), 25°C

CORE LOSSES

P _L max	Production lot limit Max avg	Test conditions
25.0 mW (110 mW/cm ³)	22.7 mW (100 mW/cm ³)	100 kHz, 100 mT, 100°C
163 mW (715 mW/cm ³)	148 mW (650 mW/cm ³)	100 kHz, 200 mT, 100°C

COATING

Parylene rated for 130°C continuous operation.
Voltage breakdown rating 1500 V_{DC} Min Wire-to-Wire.

NOTE

Spec. Modifications	Previous	Revised
2006.06.20	Losses: General R material	Losses: Detail as indicated