

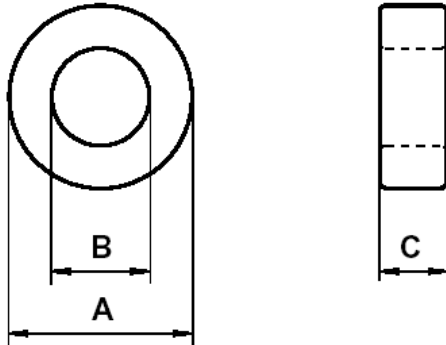

Specification for:
YR40401TC

110 Delta Drive
Pittsburgh, PA 15238
Phone: 412/696-1333
Fax: 412/696-0333
Email:magnetics@spang.com

DIMENSIONS



(mm)	Uncoated Nominal:	Coated Min:	Coated Max:
O.D. (A)	4.83	4.55	5.11
I.D. (B)	2.29	2.00	2.58
Ht. (C)	1.27	1.02	1.53

Eff. Parameters		
A _e mm ²	l _e mm	V _e mm ³
1.54	10.21	15.72

INDUCTANCE

AL value (nH/T ²)	Test conditions
440 ± 25%	10 kHz, 0.5 mT (For N = 5, use 0.21 mA), 25°C

CORE LOSSES

P _L max	Production lot limit Max avg	Test conditions
1.73 mW (110 mW/cm ³)	1.57 mW (100 mW/cm ³)	100 kHz, 100 mT, 100°C
11.24 mW (715 mW/cm ³)	10.22 mW (650 mW/cm ³)	100 kHz, 200 mT, 100°C

COATING

Parylene rated for 130°C continuous operation.
Voltage breakdown rating 1000 V Min Wire-to-Wire.

NOTE

Spec. Modifications	Previous	Revised
2007.05.14	Losses: General R material	Losses: Detail as indicated