

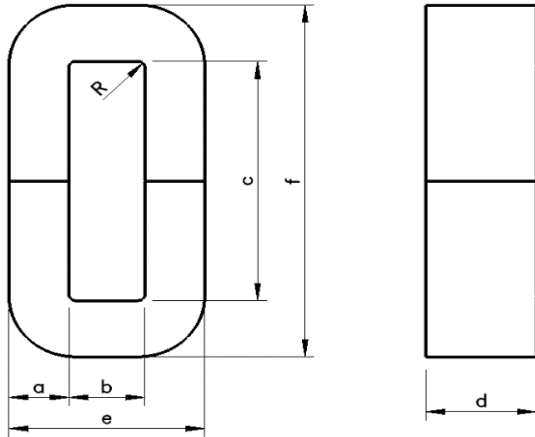

PTB053035020HCC

110 Delta Drive
 Pittsburgh, PA 15238
 NAFTA Sales: (1) 800-245-3984
 HK Sales: (852) 3102-9337
 magnetics@spang.com
 www.mag-inc.com



	Dim (mm)	tol +/-
a	11.0	0.8
b	12.5	min
c	29.5	min
d	20.0	0.5
e	35.0	1.0
f	53.0	1.5
R	2.0	ref

A_e (cm ²)	L_e (cm)	Weight (g)	AL	Conditions	
2	11.7	170 Ref	10.0 μ H min (REF)	10 kHz	2 mT

Material	Nanocrystalline
Saturation Flux Density	1.25 T
Initial Permeability	80,000
Curie Temperature	560°C
Continuous Working Temperature	-40°C + 155°C