

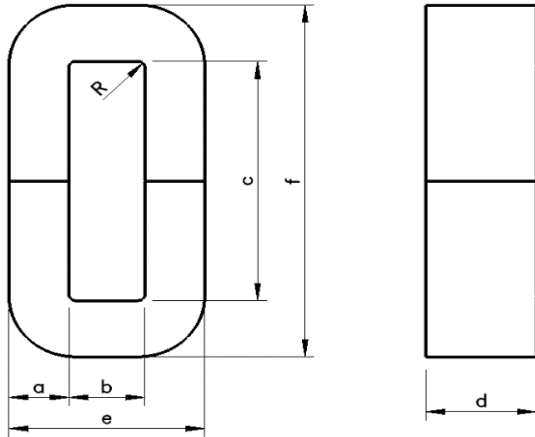

PTB053031020HCC

110 Delta Drive
 Pittsburgh, PA 15238
 NAFTA Sales: (1) 800-245-3984
 HK Sales: (852) 3102-9337
 magnetics@spang.com
 www.mag-inc.com



	Dim (mm)	tol +/-
a	10.0	0.8
b	10.0	min
c	33.0	min
d	20.0	0.5
e	31.0	1.0
f	53.0	1.5
R	2.0	ref

A_e (cm ²)	L_e (cm)	Weight (g)	A_L	Conditions
1.6	12.8	150 Ref	9.0 μ H min (REF)	10 kHz 2 mT

Material	Nanocrystalline
Saturation Flux Density	1.25 T
Initial Permeability	80,000
Curie Temperature	560°C
Continuous Working Temperature	-40°C + 155°C