

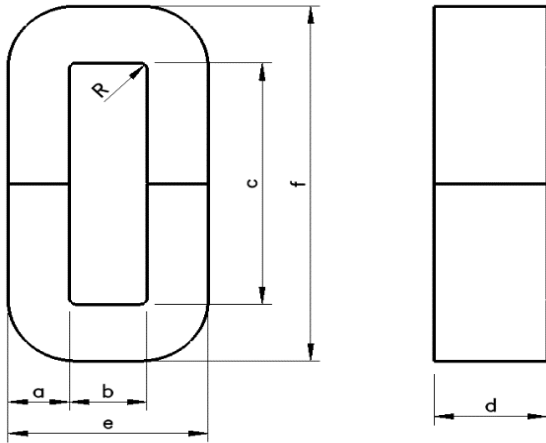

MACC0006P3

110 Delta Drive
 Pittsburgh, PA 15238
 NAFTA Sales: (1) 800-245-3984
 HK Sales: (852) 3102-9337
 magnetics@spang.com
 www.mag-inc.com



	Dim (mm)	tol +/-
a	10.0	0.8
b	10.0	min
c	33.0	min
d	20.0	0.5
e	31.0	1.0
f	53.0	1.5
R	2.0	ref

$A_e(\text{cm}^2)$	$L_e(\text{cm})$	Weight (g)	$W_a(\text{cm}^2)$
1.6	12.8	150 Ref	3.6 ref

Material	Amorphous
Core Loss (@16kHz/37mT, 25° C +/- 3° C, Humidity 65% +/- 5%)	≤1.0 W/kg
Working Temperature	-40°C + 130°C
Storage Temperature	-40°C + 80°C