

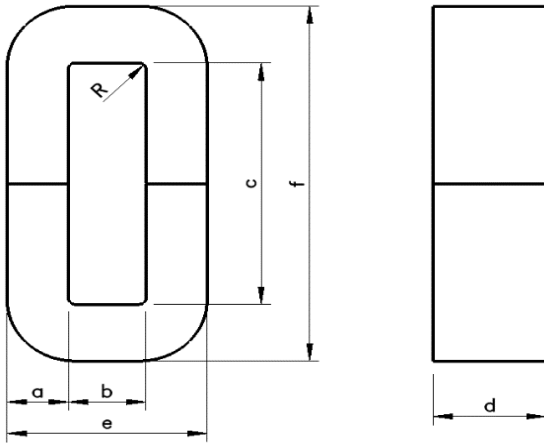

**MACC0004**

110 Delta Drive  
 Pittsburgh, PA 15238  
 NAFTA Sales: (1) 800-245-3984  
 HK Sales: (852) 3102-9337  
 magnetics@spang.com  
 www.mag-inc.com



	Dim (mm)	tol +/-
a	9.0	0.8
b	9.0	min
c	32.0	min
d	15.0	0.5
e	28.0	1.0
f	51.0	1.5
R	2.0	ref

$A_e(\text{cm}^2)$	$L_e(\text{cm})$	Weight (g)	$W_a(\text{cm}^2)$
1.24	10.7	97 Ref	3.3 ref

Material	Amorphous
Core Loss (@16kHz/37mT, 25° C +/- 3° C, Humidity 65% +/- 5%)	≤1.0 W/kg
Working Temperature	-40°C + 130°C
Storage Temperature	-40°C + 80°C