

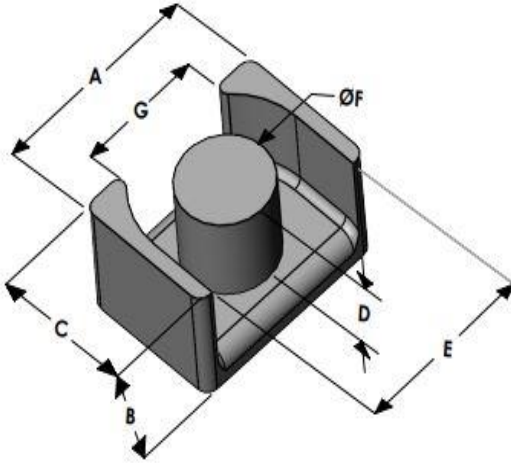

LPX4225E060L123

110 Delta Drive
 Pittsburgh, PA 15238
 NAFTA Sales: (1)800-245-3984
 HK Sales : (852)3102-9337
 magnetics@spang.com
 www.mag-inc.com



XFlux Permeability (μ)	A_L (nH/T ²)	Core Marking	
		Lot Number	Part number
60	204 ± 8%	XXXXXX	LPX4225E060L123

	Dimensions		Tolerance (\pm)		Packaging
	(mm)	(in)	(mm)	(in)	
A	42.00	1.654	0.50	0.020	Box Qty: 180
B	12.30	0.484	0.20	0.008	
C	25.00	0.984	0.30	0.012	
D	7.90	0.311	0.20	0.008	Available Hardware
E	35.20	1.386	0.40	0.016	
F	16.20	0.638	0.30	0.012	
G	27.25	1.073	0.35	0.014	

Electrical Characteristics			Physical Characteristics					
Watt Loss @ 50 kHz, 100 mT typical (mW/cm ³)	DC Bias typical (Oersted)		Break Strength typical (kg)	Window Area W_A (mm ²)	Cross Section A_e (mm ²)	Path Length L_e (mm)	Volume V_e (mm ³)	Weight (Ea. Piece) (g)
	80%	50%						
410	115	190	53	216	206.0	76.1	15,680	52.1

Notes:	Temperature Rating
	Curie Temp: 500°C

