

DIMENSIONS

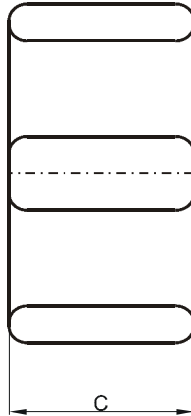
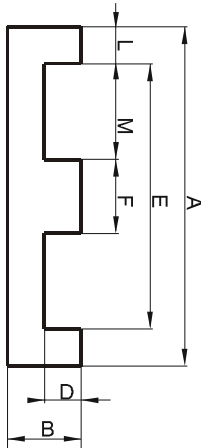

(mm)	Nominal:	Tol. min.:	Tol. max.:
A	21.8	-0.4	+ 0.4
B	5.72	-0.12	+ 0.12
C	15.8	-0.3	+ 0.3
D	3.05 Min.		
E	16.1 Min.		
F	5.08	-0.12	+ 0.12
L	2.5 Ref.		
M	5.9 Ref.		
Eff. Parameters			
Ae mm²	Amin mm²	le mm	Ve mm³
78.5	76.0	32.5	2550

INDUCTANCE

AL value (nH/T²)	Test conditions
2400 ± 25%	10 kHz, < 0.5 mT, 25 °C

MARKING

No marking

CORE LOSSES

P_i max	Test conditions
227 mW/cm ³ (0.58 W/set)	1000 kHz, 30 mT, 100 °C
Ref. 400 mW/cm ³ (1.02 W/set)	3000 kHz, 10 mT, 100 °C