

Specification for:

FF44310EC

110 Delta Drive
Pittsburgh, PA 15238
Phone: 412/696-1333
Fax: 412/696-0333
Email: magnetics@spang.com

DIMENSIONS

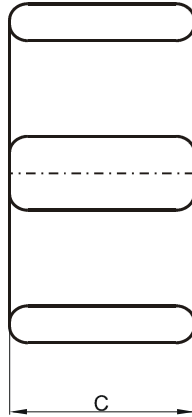
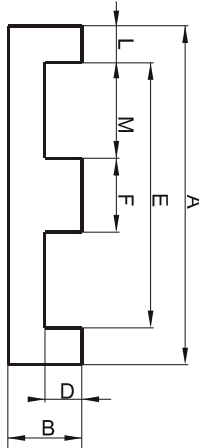

(mm)	Nominal:	Tol. min.:	Tol. max.:
A	43.2	-0.9	+ 0.9
B	9.5	-0.13	+ 0.13
C	27.9	-0.6	+ 0.6
D	5.4	-0.13	+ 0.13
E	34.7 MIN.		
F	8.1	-0.2	+ 0.2
L	4.7 MAX.		
M	13.2 MIN.		
Eff. Parameters			
Ae mm²	Amin mm²	le mm	Ve mm³
229.0	229.0	61.1	13900

INDUCTANCE

AL value (nH)	Test conditions
10450 ± 25%	10 kHz, < 0.5 mT, 25 °C

MARKING

FF44310EC PXXXXX

CORE LOSSES

P _i max	Test conditions
209 mW/cm ³ (2.9 W/set)	25 kHz, 200 mT, 100 °C

NOTE

Spec. modifications	Previous	Revised
2005-06-22	A=43.69 MAX. A=42.67 MIN. B=9.40 MIN. C=28.32 MAX. C=27.56 MIN. D=5.33 MIN. L=4.32 MAX LOSSES: GENERAL F MATERIAL	A=44.1 MAX. A=42.3 MIN. B=9.37 MIN. C=28.5 MAX. C=27.3 MIN. D=5.27 MIN. L=4.7 MAX LOSSES: DETAIL AS INDICATED