

Specification for:

CR41434IC

11 Drive
Pittsburgh, PA 15238
Phone: 412/696-1333
Fax: 412/696-0333
Email: magnetics@spang.com

DIMENSIONS

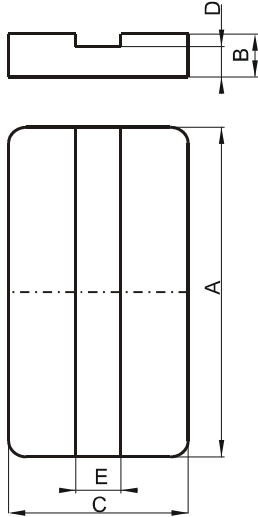

(mm)	Nominal:	Tol. min.:	Tol. max.:
A	14.0	-0.3	+ 0.3
B	1.8	-0.05	+ 0.05
C	5.0	-0.15	+ 0.15
D	1.5	-0.1	+ 0.1
E	2.5	0.0	+ 0.2
Eff. Parameters (with C_41434EC)			
Ae mm²	Amin mm²	le mm	Ve mm³
14.2	11.4	16.4	230

INDUCTANCE

AL value (nH)	Test conditions
Nom: 1504 Min.: 1128	10 kHz, < 0.5 mT, 25 °C

MARKING

R IC

CORE LOSSES

P _i max	Test conditions
98 mW/cm ³ (0.024 W/set)	100 kHz, 100 mT, 100 °C
653 mW/cm ³ (0.16 W/set)	100 kHz, 200 mT, 100 °C

NOTE

Spec. modifications	Previous	Revised
2005-06-22	Al= 1330 Min. Losses: General R material	Al= 1128 Min. Losses: Detail as indicated