

DIMENSIONS

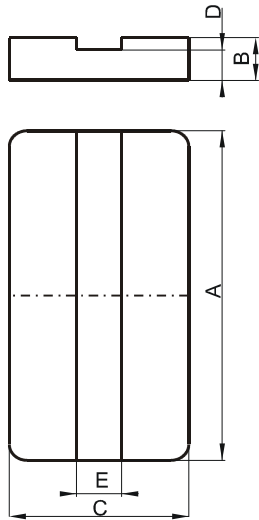

(mm)	Nominal:	Tol. min.:	Tol. max.:
A	18.0	-0.35	+ 0.35
B	2.4	-0.05	+ 0.05
C	10.0	-0.2	+ 0.2
D	2.0	-0.1	+ 0.1
E	2.5	0.0	+ 0.2
Eff. Parameters (with C_41805EC)			
Ae mm²	Amin mm²	le mm	Ve mm³
39.5	35.9	20.3	830

INDUCTANCE

MARKING

AL value (nH/T²)	Test conditions (with CP41805EC)	P
Nom: 3801 Min.: 2851	10 kHz, < 0.5 mT, 25 °C	IC

CORE LOSSES

P_i max	Test conditions
114 mW/cm ³ (0.095 W/set)	100 kHz, 100 mT, 100 °C

NOTE

Spec. modifications	Previous	Revised
2005-06-16	Losses: General P material	Losses: Detail as indicated