

DIMENSIONS

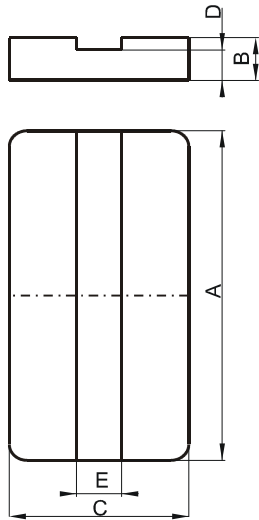

(mm)	Nominal:	Tol. min.:	Tol. max.:
A	14.0	-0.3	+ 0.3
B	1.8	-0.05	+ 0.05
C	5.0	-0.15	+ 0.15
D	1.5	-0.1	+ 0.1
E	2.5	0.0	+ 0.2
Eff. Parameters (with C_41434EC)			
Ae mm²	Amin mm²	le mm	Ve mm³
14.2	11.4	16.4	230

INDUCTANCE

MARKING

AL value (nH/T²)	Test conditions (with CP41434EC)	P
Nom: 1580 Min.: 1185	10 kHz, < 0.5 mT, 25 °C	IC

CORE LOSSES

P_i max	Test conditions
106 mW/cm ³ (0.026 W/set)	100 kHz, 100 mT, 100 °C

NOTE

Spec. modifications	Previous	Revised
2005-06-22	Al=1450 Min. Losses: General P material	Al=1185 Min. Losses: Detail as indicated