

DIMENSIONS

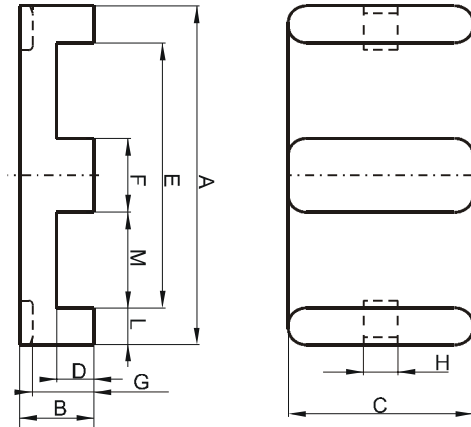

(mm)	Nominal:	Tol. min.:	Tol. max.:
A	21.8	-0.4	+ 0.4
B	5.7	-0.1	+ 0.1
C	15.8	-0.3	+ 0.3
D	3.2	-0.1	+ 0.1
E	16.8	-0.4	+ 0.4
F	5.0	-0.1	+ 0.1
G	4.68	-0.15	+ 0.15
H	2.8	0.0	+ 0.2
L	2.5 Ref.		
M	5.9 Ref.		
Eff. Parameters			
Ae mm²	Amin mm²	le mm	Ve mm³
76.0	73.1	32.3	2451

INDUCTANCE

AL value (nH/T²)	Test conditions
2300 ± 25%	10 kHz, < 0.5 mT, 25 °C

MARKING

No marking

CORE LOSSES

P_i max	Test conditions
228 mW/cm ³ (0.56 W/set)	1000 kHz, 30 mT, 100 °C
Ref. 400 mW/cm ³ (0.98 W/set)	3000 kHz, 10 mT, 100 °C