

Specification for:

CF42216IC

110 Delta Drive
Pittsburgh, PA 15238
Phone: 412/696-1333
Fax: 412/696-0333
Email: magnetics@spang.com

DIMENSIONS

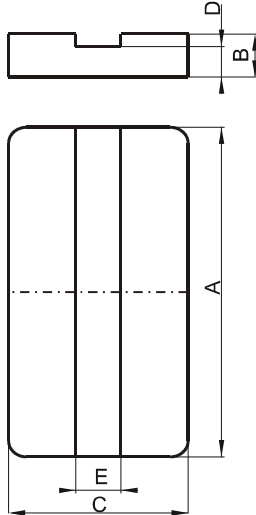

(mm)	Nominal:	Tol. min.:	Tol. max.:
A	21.8	-0.4	+ 0.4
B	2.9	-0.05	+ 0.05
C	15.8	-0.3	+ 0.3
D	2.5	-0.1	+ 0.1
E	2.9	0.0	+ 0.2
Eff. Parameters (with C_42216EC)			
Ae mm²	Amin mm²	le mm	Ve mm³
80.4	72.5	26.1	2100

INDUCTANCE

AL value (nH)	Test conditions (with CF42216EC)
7327 ± 25%	10 kHz, < 0.5 mT, 25 °C

MARKING

F IC

CORE LOSSES

P _i max	Test conditions
205 mW/cm ³ (0.43 W/set)	25 kHz, 200 mT, 100 °C

NOTE

Spec. modifications	Previous	Revised
2005-06-22	AL=7776±25% A=21.6±0.26 C=15.62 Min. Losses: General F material	AL=7327±25% A=21.8±0.4 C=15.5 Min. Losses: Detail as indicated