

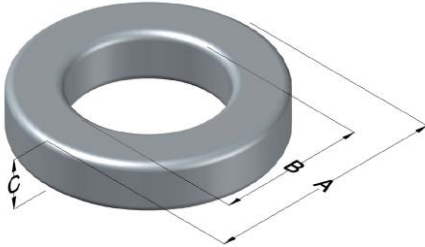

# C055930A9

110 Delta Drive  
 Pittsburgh, PA 15238  
 NAFTA Sales: (1)800-245-3984  
 HK Sales : (852)3102-9337  
 magnetics@spang.com  
 www.mag-inc.com



MPP Permeability ( $\mu$ )	$A_L$ (nH/T <sup>2</sup> )	Core Marking			Coating Color
		Lot Number	Part Number	Inductance Grade	
125	157 $\pm$ 8%	XXXXXX	55930A9	X	Gray

Dimensions	Uncoated		Coated Limits			Packaging
	(mm)	(in)	(mm)	(in)		
OD (A)	26.90	1.060	28.07	1.105	max	Cardboard cut-outs Box Qty= 400 pcs
ID (B)	14.73	0.580	13.72	0.540	min	
HT (C)	11.18	0.440	12.32	0.485	max	

Electrical Characteristics			Physical Characteristics						
Watt Loss @ 100 kHz, 100mT max (mW/cm <sup>3</sup> )	DC Bias min (oersteds)		Voltage Breakdown wire to wire min (V <sub>AC</sub> )	Break Strength min (kg)	Window Area W <sub>A</sub> (mm <sup>2</sup> )	Cross Section A <sub>e</sub> (mm <sup>2</sup> )	Path Length L <sub>e</sub> (mm)	Volume V <sub>e</sub> (mm <sup>3</sup> )	Weight (g)
	80%	50%							
900	25.0	48.5	8000	77.0	148	65.4	63.5	4,150	36

Winding Information					Temperature Rating	
Winding Length Per Turn				Wound Coil Dimensions (mm)		Curie Temp: 460 °C
Winding Factor	(mm)	Winding Factor	(mm)	40% Winding Factor	OD	30.0
					HT	16.5
				Completely Full Window	Max OD	37.3
					Max HT	24.0
0%	37.5	40%	44.6	Surface Area (mm <sup>2</sup> )		
20%	41.1	45%	45.7			
25%	41.9	50%	46.6	Unwound Core		
30%	42.8	60%	48.8	2,400		
35%	43.8	70%	51.3	40% Winding Factor		
				3,500		
Coating Temp (Continuous up to): 200 °C						
Notes:						

