

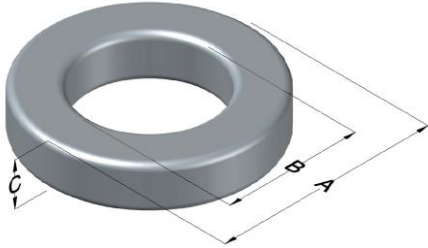

# C055930A2HT23

110 Delta Drive  
 Pittsburgh, PA 15238  
 NAFTA Sales: (1)800-245-3984  
 HK Sales : (852)3102-9337  
 magnetics@spang.com  
 www.mag-inc.com



MPP Permeability ( $\mu$ )	$A_L$ (nH/T <sup>2</sup> )	Core Marking			Coating Color
		Lot Number	Part Number	Inductance Grade	
125	314 ± 8%	XXXXXX	55930A2HT23	X	Gray

Dimensions	Uncoated		Coated Limits			Packaging
	(mm)	(in)	(mm)	(in)		
OD (A)	26.90	1.060	27.69	1.090	max	Cardboard cut-outs Box Qty= 200 pcs
ID (B)	14.7	0.580	14.1	0.555	min	
HT (C)	22.4	0.880	23.0	0.905	max	

Electrical Characteristics			Physical Characteristics						
Watt Loss @ 100 kHz, 100mT max (mW/cm <sup>3</sup> )	DC Bias min (oersteds)		Voltage Breakdown wire to wire min (V <sub>AC</sub> )	Break Strength min (kg)	Window Area W <sub>A</sub> (mm <sup>2</sup> )	Cross Section A <sub>e</sub> (mm <sup>2</sup> )	Path Length L <sub>e</sub> (mm)	Volume V <sub>e</sub> (mm <sup>3</sup> )	Weight (g)
	80%	50%							
900	25.0	48.5	2000	77.0	156	131	63.5	8320	72

Winding Information					Temperature Rating	
Winding Length Per Turn				Wound Coil Dimensions (mm)		Curie Temp: 460 °C
Winding Factor	(mm)	Winding Factor	(mm)	40% Winding Factor		Coating Temp (Continuous up to): 200 °C
				OD	30.0	Notes:
0%	59.6	40%	66.8	HT	27.5	
				Max OD	37.3	
20%	63.1	45%	67.8	Max HT	35.0	
25%	64.0	50%	68.7	Surface Area (mm <sup>2</sup> )		
30%	64.9	60%	70.9	Unwound Core	3,900	
35%	65.8	70%	73.4	40% Winding Factor	5,100	

## Typical DC Bias Performance

