

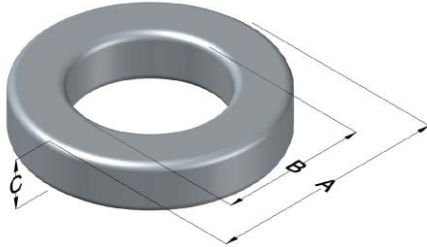

**C055924A2**

110 Delta Drive  
 Pittsburgh, PA 15238  
 NAFTA Sales: (1)800-245-3984  
 HK Sales : (852)3102-9337  
 magnetics@spang.com  
 www.mag-inc.com



MPP Permeability ( $\mu$ )	$A_L$ (nH/T <sup>2</sup> )	Core Marking			Coating Color
		Lot Number	Part Number	Inductance Grade	
173	217 $\pm$ 8%	XXXXXX	55924A2	X	Gray

Dimensions	Uncoated		Coated Limits			Packaging
	(mm)	(in)	(mm)	(in)		
OD (A)	26.90	1.060	27.69	1.090	max	Cardboard cut-outs Box Qty= 400 pcs
ID (B)	14.7	0.580	14.1	0.555	min	
HT (C)	11.2	0.440	12.0	0.470	max	

Electrical Characteristics			Physical Characteristics						
Watt Loss @ 100 kHz, 100mT max (mW/cm <sup>3</sup> )	DC Bias min (oersteds)		Voltage Breakdown wire to wire min (V <sub>AC</sub> )	Break Strength min (kg)	Window Area W <sub>A</sub> (mm <sup>2</sup> )	Cross Section A <sub>e</sub> (mm <sup>2</sup> )	Path Length L <sub>e</sub> (mm)	Volume V <sub>e</sub> (mm <sup>3</sup> )	Weight (g)
	80%	50%							
900	20.0	36.5	2000	77.0	156	65.4	63.5	4,150	37

Winding Information					Temperature Rating	
Winding Length Per Turn				Wound Coil Dimensions (mm)		Curie Temp: 460 °C
Winding Factor	(mm)	Winding Factor	(mm)	40% Winding Factor		Coating Temp (Continuous up to): 200 °C
				OD	30.0	Notes:
				HT	16.5	
				Completely Full Window		
				Max OD	37.3	
				Max HT	24.0	
				Surface Area (mm <sup>2</sup> )		
				Unwound Core	2,400	
				40% Winding Factor	3,500	
0%	37.5	40%	44.6			
20%	41.1	45%	45.7			
25%	41.9	50%	46.6			
30%	42.8	60%	48.8			
35%	43.8	70%	51.3			

**Typical DC Bias Performance**

