

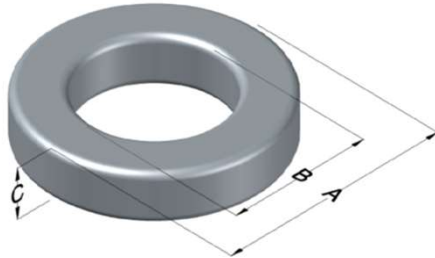

C055894A2HT32

110 Delta Drive
 Pittsburgh, PA 15238
 NAFTA Sales: (1)800-245-3984
 HK Sales : (852)3102-9337
 magnetics@spang.com
 www.mag-inc.com



MPP Permeability (μ)	A_L (nH/T ²)	Core Marking			Coating Color
		Lot Number	Part Number	Inductance Grade	
60	206 ± 8%	XXXXXX	55894A2HT32	X	Grey

Dimensions	Uncoated		Coated Limits			Packaging
	(mm)	(in)	(mm)	(in)		
OD (A)	26.92	1.060	27.69	1.090	max	Cardboard cut-outs Box Qty = 160
ID (B)	14.73	0.580	14.10	0.555	min	
HT (C)	30.99	1.220	32.00	1.260	max	

Electrical Characteristics			Physical Characteristics						
Watt Loss @ 100kHz, 100mT max (mW/cm ³)	DC Bias min (oersteds)		Voltage Breakdown wire to wire min (V _{AC})	Break Strength min (kg)	Window Area W _a (mm ²)	Cross Section A _e (mm ²)	Path Length L _e (mm)	Volume V _e (mm ³)	Weight (g)
	80%	50%							
700	50	94	3000	77.0	156	186	63.5	11,800	98.5

Winding Information					Temperature Rating	
Winding Length Per Turn				Wound Coil Dimensions (mm)		Curie Temp: 460°C
Winding Factor	(mm)	Winding Factor	(mm)	40% Winding Factor	OD	30.9
					HT	36.8
0%	77.6	40%	84.9	Completely Full Window	Max OD	30.9
20%	81.2	45%	85.8		Max HT	41.6
25%	82.2	50%	87.0	Surface Area (mm ²)		
30%	82.9	60%	89.1	Unwound Core	5,100	
35%	83.9	70%	91.6	40% Winding Factor	6,000	
Coating Temp (Continuous up to): 200°C						
Notes:						

