

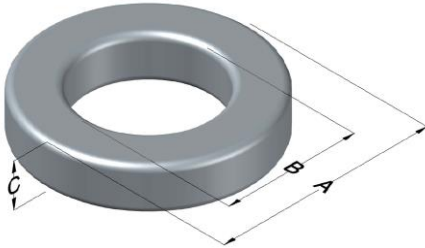

C055894A2HT21

110 Delta Drive
 Pittsburgh, PA 15238
 NAFTA Sales: (1)800-245-3984
 HK Sales : (852)3102-9337
 magnetics@spang.com
 www.mag-inc.com



MPP Permeability (μ)	A_L (nH/T ²)	Core Marking			Coating Color
		Lot Number	Part Number	Inductance Grade	
60	132 ± 8%	XXXXXX	55894A2HT21	X	Gray

Dimensions	Uncoated		Coated Limits			Packaging
	(mm)	(in)	(mm)	(in)		
OD (A)	26.90	1.060	27.69	1.090	max	Cardboard cut-outs Box Qty= 240 pcs
ID (B)	14.7	0.580	14.1	0.555	min	
HT (C)	19.7	0.774	21.0	0.826	max	

Electrical Characteristics			Physical Characteristics						
Watt Loss @ 100 kHz, 100mT max (mW/cm ³)	DC Bias min (oersteds)		Voltage Breakdown wire to wire min (V _{AC})	Break Strength min (kg)	Window Area W _A (mm ²)	Cross Section A _e (mm ²)	Path Length L _e (mm)	Volume V _e (mm ³)	Weight (g)
	700	80%							
	50.0	94.0							

Winding Information					Temperature Rating	
Winding Length Per Turn				Wound Coil Dimensions (mm)		Curie Temp: 460 °C
Winding Factor	(mm)	Winding Factor	(mm)	40% Winding Factor		Coating Temp (Continuous up to): 200 °C
				OD	30.0	Notes:
				HT	25.5	
				Max OD	37.3	
				Max HT	23.0	
0%	55.6	40%	62.8	Surface Area (mm ²)		
20%	59.1	45%	63.8	Unwound Core		
25%	60.0	50%	64.7	4,800		
30%	60.9	60%	66.9	40% Winding Factor		
35%	61.8	70%	69.4	4,800		

Typical DC Bias Performance

