

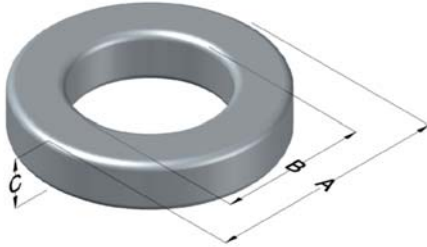

C055777A2

110 Delta Drive
 Pittsburgh, PA 15238
 NAFTA Sales: (1)800-245-3984
 HK Sales : (852)3102-9337
 magnetics@spang.com
 www.mag-inc.com



MPP Permeability (μ)	A_L (nH/T ²)	Core Marking			Coating Color
		Lot Number	Part Number	Inductance Grade	
60	205 \pm 8%	XXXXXX	55777A2	X	Grey

Dimensions	Uncoated		Coated Limits			Packaging
	(mm)	(in)	(mm)	(in)		
OD (A)	77.80	3.063	78.95	3.108	max	Cardboard cut-outs
ID (B)	39.34	1.549	38.34	1.509	min	
HT (C)	25.85	1.018	26.85	1.057	max	

Electrical Characteristics			Physical Characteristics						
Watt Loss @ 100 kHz, 100mT max (mW/cm ³)	DC Bias min (A-T/cm)		Voltage Breakdown wire to wire min (V _{AC})	Break Strength min (kg)	Window Area W _A (mm ²)	Cross Section A _e (mm ²)	Path Length L _e (mm)	Volume V _e (mm ³)	Weight (g)
	80%	50%							
700	39.8	74.7	2000	108	1,150	478	170	81,500	660

Winding Information					Temperature Rating	
Winding Length Per Turn				Wound Coil Dimensions (mm)		Curie Temp: 460°C
Winding Factor	(mm)	Winding Factor	(mm)	40% Winding Factor	OD	91.0
					HT	45.4
0%	94.3	40%	114	Completely Full Window	Max OD	117
20%	104	45%	117		Max HT	69.3
25%	107	50%	120	Surface Area (mm ²)		
30%	109	60%	126	Unwound Core		19,000
35%	112	70%	132	40% Winding Factor		32,000
Coating Temp (Continuous up to): 200°C						
Notes:						

Typical DC Bias Performance

