

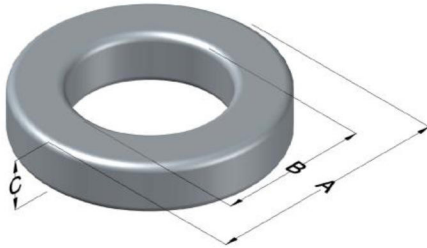

C055432A9

110 Delta Drive
 Pittsburgh, PA 15238
 NAFTA Sales: (1)800-245-3984
 HK Sales : (852)3102-9337
 magnetics@spang.com
 www.mag-inc.com



MPP Permeability (μ)	A_L (nH/T ²)	Core Marking			Coating Color
		Lot Number	Part Number	Inductance Grade	
173	390 \pm 8%	XXXXXX	55432A9	X	Gray

Dimensions	Uncoated		Coated Limits			Packaging
	(mm)	(in)	(mm)	(in)		
OD (A)	46.74	1.840	48.00	1.890	max	Cardboard cut-outs Box Qty= 105 pcs
ID (B)	24.13	0.950	22.94	0.902	min	
HT (C)	18.03	0.710	19.30	0.763	max	

Electrical Characteristics			Physical Characteristics						
Watt Loss @ 100 kHz, 100mT max (mW/cm ³)	DC Bias min (oersteds)		Voltage Breakdown wire to wire min (V _{AC})	Break Strength min (kg)	Window Area W _A (mm ²)	Cross Section A _e (mm ²)	Path Length L _e (mm)	Volume V _e (mm ³)	Weight (g)
	80%	50%							
900	20	36.5	8000	233	413	199	107	21,300	180

Winding Information					Temperature Rating	
Winding Length Per Turn				Wound Coil Dimensions (mm)		Curie Temp: 460 °C
Winding Factor	(mm)	Winding Factor	(mm)	40% Winding Factor		Coating Temp (Continuous up to): 200 °C
				OD	51.2	Notes:
0%	62.1	40%	74.1	HT	26.0	
				Max OD	63.8	
20%	68.2	45%	76.0	Max HT	38.7	
25%	69.7	50%	77.6	Surface Area (mm ²)		
30%	70.9	60%	81.2	Unwound Core	6,900	
35%	72.7	70%	85.4	40% Winding Factor	9,600	

