

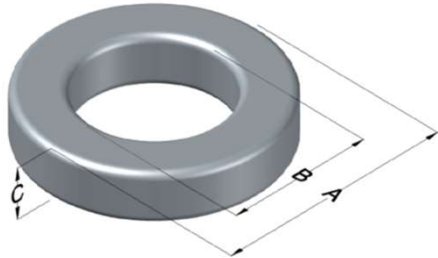

C055406A2

110 Delta Drive
 Pittsburgh, PA 15238
 NAFTA Sales: (1)800-245-3984
 HK Sales : (852)3102-9337
 magnetics@spang.com
 www.mag-inc.com



MPP Permeability (μ)	A_L (nH/T ²)	Core Marking			Coating Color
		Lot Number	Part Number	Inductance Grade	
550	298 \pm 8%	XXXXXX	55406A2	X	Grey

Dimensions	Uncoated		Coated Limits			Packaging
	(mm)	(in)	(mm)	(in)		
OD (A)	6.86	0.270	7.49	0.295	max	Bulk Pack 4 bags/box Box Qty= 10,000 pcs
ID (B)	3.96	0.156	3.45	0.136	min	
HT (C)	5.08	0.200	5.72	0.225	max	

Electrical Characteristics			Physical Characteristics						
Watt Loss @ 100kHz, 100mT max (mW/cm ³)	DC Bias min (oersteds)		Voltage Breakdown wire to wire min (V _{AC})	Break Strength min (kg)	Window Area W _a (mm ²)	Cross Section A _e (mm ²)	Path Length L _e (mm)	Volume V _e (mm ³)	Weight (g)
	80%	50%							
2000	1.9	4.2	1250	10.0	9.35	7.14	17	118	1.00

Winding Information					Temperature Rating	
Winding Length Per Turn				Wound Coil Dimensions (mm)		Curie Temp: 460°C
Winding Factor	(mm)	Winding Factor	(mm)	40% Winding Factor	OD	7.89
					HT	6.92
0%	15.5	40%	17.3	Completely Full Window	Max OD	8.29
20%	16.3	45%	17.5		Max HT	8.12
25%	16.6	50%	17.8	Surface Area (mm ²)		
30%	16.8	60%	18.3	Unwound Core	270	
35%	17.0	70%	18.9	40% Winding Factor	310	
Notes:						
Coating Temp (Continuous up to): 200°C						

