

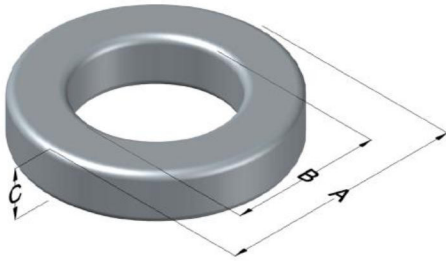

C055206W4

110 Delta Drive
 Pittsburgh, PA 15238
 NAFTA Sales: (1)800-245-3984
 HK Sales : (852)3102-9337
 magnetics@spang.com
 www.mag-inc.com



MPP Permeability (μ)	A_L (nH/T ²)	Core Marking			Coating Color
		Lot Number	Part Number	Inductance Grade	
125	68 ± 8%	XXXXXX	55206W4	X	Gray

Dimensions	Uncoated		Coated Limits			Packaging
	(mm)	(in)	(mm)	(in)		
OD (A)	20.32	0.800	21.08	0.830	max	Bulk Pack 4 bags/box Box Qty=1600 pcs
ID (B)	12.70	0.500	12.07	0.475	min	
HT (C)	6.35	0.250	7.11	0.280	max	

Electrical Characteristics			Physical Characteristics						
Watt Loss @ 100 kHz, 100mT max(mW/cm ³)	DC Bias min (oersteds)		Voltage Breakdown wire to wire min (V _{AC})	Break Strength min (kg)	Window Area W _A (mm ²)	Cross Section A _e (mm ²)	Path Length L _e (mm)	Volume V _e (mm ³)	Weight (g)
	850	80%							
	25.0	48.5							

Winding Information					Temperature Rating		
Winding Length Per Turn				Wound Coil Dimensions (mm)			Curie Temp: 460 °C
Winding Factor	(mm)	Winding Factor	(mm)	40% Winding Factor		OD	22.9
				Completely Full Window		HT	10.7
0%	23.2	40%	29.3	Max OD	29.2	Notes: W4 stabilization: Controlled stabilization with Inductance stability limits of +/- 0.25% over temperature range -55°C to +85°C measured at low drive level (<10mT). For power inductors use standard stabilization, A2.	
20%	26.3	45%	30.3	Max HT	17.4		
25%	27.0	50%	31.2	Surface Area (mm ²)			
30%	27.8	60%	32.9	Unwound Core	1,200		
35%	28.6	70%	35.1	40% Winding Factor	1,900		
							Coating Temp (Continuous to): 200 °C

