

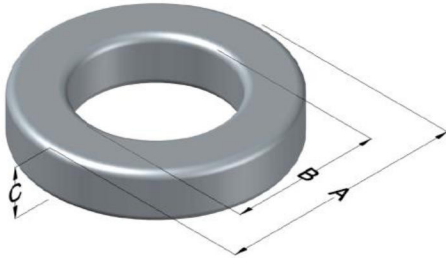

# C055204A2

110 Delta Drive  
 Pittsburgh, PA 15238  
 NAFTA Sales: (1)800-245-3984  
 HK Sales : (852)3102-9337  
 magnetics@spang.com  
 www.mag-inc.com



MPP Permeability ( $\mu$ )	$A_L$ (nH/T <sup>2</sup> )	Core Marking			Coating Color
		Lot Number	Part Number	Inductance Grade	
160	87 ± 8%	XXXXXX	55204A2	X	Gray

Dimensions	Uncoated		Coated Limits			Packaging
	(mm)	(in)	(mm)	(in)		
OD (A)	20.32	0.800	21.08	0.830	max	Bulk Pack 4 bags/box Box Qty= 1600 pcs
ID (B)	12.70	0.500	12.07	0.475	min	
HT (C)	6.35	0.250	7.11	0.280	max	

Electrical Characteristics			Physical Characteristics						
Watt Loss @ 100 kHz, 100mT max(mW/cm <sup>3</sup> )	DC Bias min (oersteds)		Voltage Breakdown wire to wire min (V <sub>AC</sub> )	Break Strength min (kg)	Window Area W <sub>A</sub> (mm <sup>2</sup> )	Cross Section A <sub>e</sub> (mm <sup>2</sup> )	Path Length L <sub>e</sub> (mm)	Volume V <sub>e</sub> (mm <sup>3</sup> )	Weight (g)
	80%	50%							
900	21.0	39.0	>2000	29.0	114	22.1	50.9	1,120	9.5880

Winding Information					Temperature Rating		
Winding Length Per Turn				Wound Coil Dimensions (mm)		Curie Temp: 460 °C	
Winding Factor	(mm)	Winding Factor	(mm)	40% Winding Factor	OD	22.9	
					HT	10.7	
				Completely Full Window	Max OD	29.2	
					Max HT	17.4	
0%	23.2	40%	29.3	Surface Area (mm <sup>2</sup> )			
20%	26.3	45%	30.3				
25%	27.0	50%	31.2	Unwound Core			
30%	27.8	60%	32.9	1,200			
35%	28.6	70%	35.1	40% Winding Factor			
				1,900			
							Coating Temp (Continuous up to): 200 °C
							Notes:

