

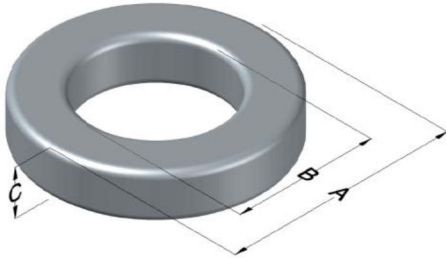

C055118M4

110 Delta Drive
 Pittsburgh, PA 15238
 NAFTA Sales: (1)800-245-3984
 HK Sales : (852)3102-9337
 magnetics@spang.com
 www.mag-inc.com



| MPP Permeability (μ) | A_L (nH/T ²) | Core Marking | | | Coating Color |
|----------------------------|----------------------------|--------------|-------------|------------------|---------------|
| | | Lot Number | Part Number | Inductance Grade | |
| 160 | 92 \pm 8% | XXXXXX | 55118M4 | X | Gray |

| Dimensions | Uncoated | | Coated Limits | | | Packaging |
|------------|----------|-------|---------------|-------|-----|--|
| | (mm) | (in) | (mm) | (in) | | |
| OD (A) | 16.59 | 0.653 | 17.27 | 0.680 | max | Bulk Pack 4 bags/box Box Qty= 2000 pcs |
| ID (B) | 10.16 | 0.400 | 9.53 | 0.375 | min | |
| HT (C) | 6.35 | 0.250 | 7.11 | 0.280 | max | |

| Electrical Characteristics | | | Physical Characteristics | | | | | | |
|---|------------------------|------|---|-------------------------|---|---|---------------------------------|--|------------|
| Watt Loss @ 100 kHz, 100mT max(mW/cm ³) | DC Bias min (oersteds) | | Voltage Breakdown wire to wire min (V _{AC}) | Break Strength min (kg) | Window Area W _A (mm ²) | Cross Section A _e (mm ²) | Path Length L _e (mm) | Volume V _e (mm ³) | Weight (g) |
| | 80% | 50% | | | | | | | |
| 900 | 21.0 | 39.0 | 1250 | 23.0 | 71.2 | 19.2 | 41.2 | 791 | 6.9360 |

| Winding Information | | | | | Temperature Rating | |
|-------------------------|------|----------------|------|---------------------------------|--------------------|--|
| Winding Length Per Turn | | | | Wound Coil Dimensions (mm) | | Curie Temp: 460 °C |
| Winding Factor | (mm) | Winding Factor | (mm) | 40% Winding Factor | | Coating Temp (Continuous to): 200 °C |
| | | | | OD | 18.8 | Notes: M4 stabilization: Controlled stabilization with Inductance stability limits of +/- 0.25% over temperature range -65°C to +125°C measured at low drive level (<10mT). For power inductors use standard stabilization, A2. |
| | | | | HT | 10.1 | |
| | | | | Max OD | 23.7 | |
| | | | | Max HT | 15.2 | |
| | | | | Surface Area (mm ²) | | |
| | | | | Unwound Core | 920 | |
| | | | | 40% Winding Factor | 1,300 | |

