



Specification for:

0W42220UC

110 Delta Drive
 Pittsburgh, PA 15238
 Phone: 412/696-1333
 Fax: 412/696-0333
 Email: magnetics@spang.com

DIMENSIONS

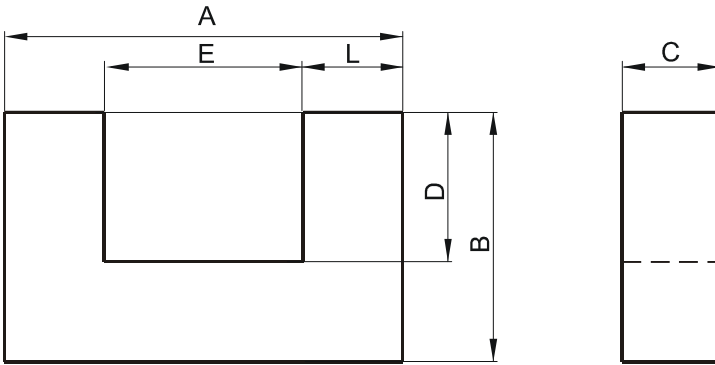

(mm)	Nominal:	Tol. min.:	Tol. max.:
A	22.1	-0.38	+ 0.38
B	20.6	-0.38	+ 0.38
C	6.27	-0.18	+ 0.18
D	13.98 Min.		
E	9.5	-0.38	+ 0.38
L	6.27	-0.18	+ 0.18
Eff. Parameters			
Ae mm ²	Amin mm ²	le mm	Ve mm ³
39.7	39.7	95.8	4130

INDUCTANCE

AL value (nH)	Test conditions
Nom: 3429 Min.: 2400	10 kHz, < 0.5 mT, 25 °C

MARKING

No marking

LOSS FACTOR

$\tan \delta/\mu$ ($\times 10^{-6}$)	Test conditions
< 3.5	10 kHz, < 0.25 mT, 25 °C
< 50	100 kHz, < 0.25 mT, 25 °C

NOTE

Spec. modifications	Previous	Revised
2005-06-22	A=22.45 Max. B=20.96 Max. E=9.14 Min. Loss factor: General W material	A=22.48 Max. B=20.98 Max. E=9.12 Min. Loss factor: Detail as indicated