

Specification for:

**0R44821EC**

110 Delta Drive  
Pittsburgh, PA 15238  
Phone: 412/696-1333  
Fax: 412/696-0333  
Email: magnetics@spang.com

**DIMENSIONS**

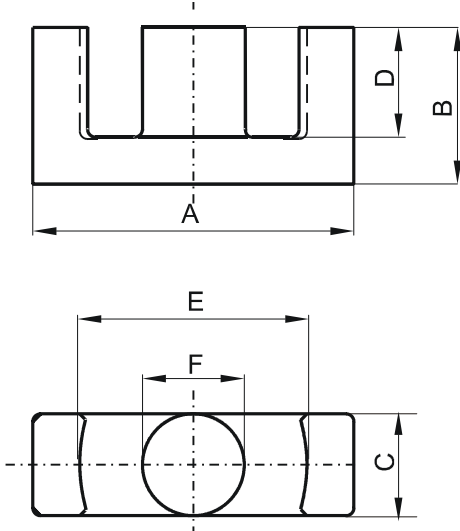

(mm)	Nominal:	Tol. min.:	Tol. max.:
<b>A</b>	48.0	-1.0	+ 1.0
<b>B</b>	21.2	-0.4	0.0
<b>C</b>	21.0	-0.5	+ 0.3
<b>D</b>	14.7	0.0	+ 0.7
<b>E</b>	38.0	-0.8	+ 0.5
<b>F</b>	18.0	-0.3	+ 0.3
<b>G</b>	0.0	0.0	0.0
Eff. Parameters			
Ae mm <sup>2</sup>	Amin mm <sup>2</sup>	le mm	Ve mm <sup>3</sup>
255.0	248.0	100.0	25500

**INDUCTANCE**

AL value (nH)	Test conditions
Nom: 5700 Min.: 4275	10 kHz, < 0.5 mT, 25 °C

**MARKING**

0R44821EC PXXXXX
---------------------

**CORE LOSSES**

P <sub>i</sub> max	Test conditions
98 mW/cm <sup>3</sup> (2.499 W/set)	100 kHz, 100 mT, 100 °C
630 mW/cm <sup>3</sup> (16.065 W/set)	100 kHz, 200 mT, 100 °C