

Specification for:  
**0R-44308-IC**

111 Zeta Drive  
Pittsburgh, PA 15238  
Phone: 412/696-1333  
Fax: 412/696-0333  
Email:magnetics@spang.com

**DIMENSIONS**

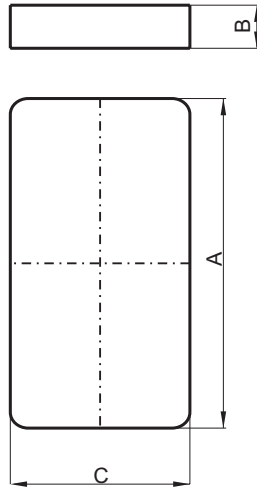

(mm)	Nominal:	Tol.min.:	Tol.max.:
(A)	43.2	-0.9	+0.9
(B)	4.1	-0.13	+0.13
(C)	27.9	-0.6	+0.6
<b>Eff. Parameters with 0R-44308-EC</b>			
<b>A<sub>e</sub> mm<sup>2</sup></b>	<b>A<sub>min.</sub> mm<sup>2</sup></b>	<b>l<sub>e</sub> mm</b>	<b>V<sub>e</sub> mm<sup>3</sup></b>
229.0	229.0	50.4	11500

**INDUCTANCE**

<b>AI value (nH) with 0R-44308-EC</b>	<b>Test conditions</b>
Nominal :10133 Minimum: 7600	10 kHz, 0.5 mT, 25°C

**CORE LOSSES**

<b>P<sub>i</sub> max</b>	<b>Test conditions</b>
104 mW/cm <sup>3</sup> (1.2 W/set) 608 mW/cm <sup>3</sup> (7.0 W/set)	100 kHz, 100 mT, 100°C 100 kHz, 200 mT, 100°C

**MARKING**

Marking: 0R44308IC PXXXXX
------------------------------

**NOTE**

<b>Spec. modification</b>	<b>Previous</b>	<b>Revised</b>
2005.06.16	A=43.7 MAX. A=42.7 MIN. C=28.3 MAX. C=27.6 MIN. LOSSES: GENERAL R MATERIAL	A=44.1 MAX. A=42.3 MIN. C=28.5 MAX. C=27.3 MIN. LOSSES: DETAIL AS INDICATED