

Specification for:

0R44125UC

110 Delta Drive
Pittsburgh, PA 15238
Phone: 412/696-1333
Fax: 412/696-0333
Email: magnetics@spang.com

DIMENSIONS

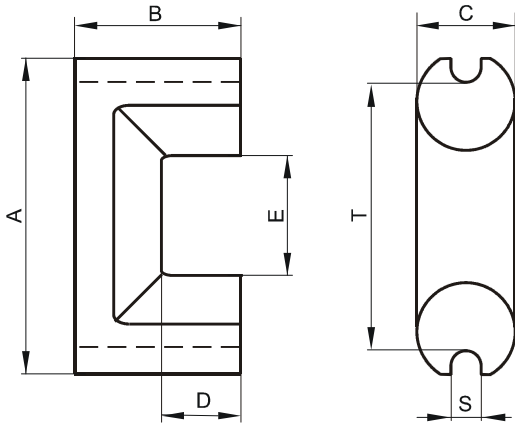

(mm)	Nominal:	Tol. min.:	Tol. max.:
A	41.78	-0.81	+ 0.81
B	25.4	-0.13	+ 0.13
C	11.94	-0.25	+ 0.25
D	15.9	-0.2	+ 0.2
E	18.8	-0.56	+ 0.56
S	3.18	-0.13	+ 0.13
T	34.66 Nom.		
Eff. Parameters			
Ae mm ²	Amin mm ²	le mm	Ve mm ³
113.1	105.4	134.4	15196

INDUCTANCE

AL value (nH)	Test conditions
Nom: 1600 Min.: 1200	10 kHz, < 0.5 mT, 25 °C

MARKING

R UC

CORE LOSSES

P _i max	Test conditions
112 mW/cm ³ (1.7 W/set)	100 kHz, 100 mT, 100 °C
619 mW/cm ³ (9.4 W/set)	100 kHz, 200 mT, 100 °C

NOTE

Spec. modifications	Previous	Revised
2005-06-22	A=42.37 Max. A=41.55 Min. C=11.94 Max. E=18.42 Min. T=35.3 Ref. Losses: General R material	A=42.59 Max. A=40.97 Min. C=12.19 Max. E=18.24 Min. T=34.66 Ref. Losses: Detail as indicated