

DIMENSIONS

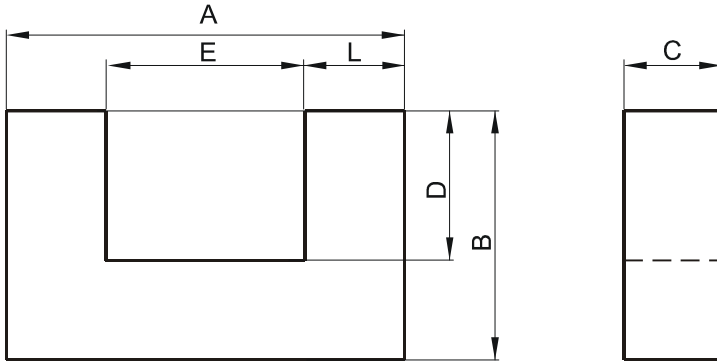

(mm)	Nominal:	Tol. min.:	Tol. max.:
A	25.4	-0.51	+ 0.51
B	15.9 Ref.		
C	12.7	-0.25	+ 0.25
D	9.27 Min.		
E	12.7 Ref.		
L	6.45	-0.15	+ 0.15
Eff. Parameters			
Ae mm ²	Amin mm ²	le mm	Ve mm ³
80.8	80.8	83.4	6740

INDUCTANCE

MARKING

AL value (nH/T ²)	Test conditions	R UC
Nom: 2093 Min.: 1570	10 kHz, < 0.5 mT, 25 °C	

CORE LOSSES

P _i max	Test conditions
91 mW/cm ³ (0.61 W/set)	100 kHz, 100 mT, 100 °C
549 mW/cm ³ (3.7 W/set)	100 kHz, 200 mT, 100 °C

NOTE

Spec. modifications	Previous	Revised
2005-06-22	L=6.35 +0/-0.12 Losses: General R material	L=6.45±0.15 Losses: Detail as indicated