

**DIMENSIONS**

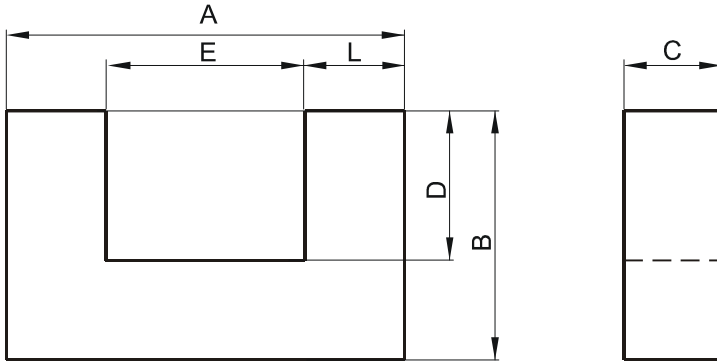

(mm)	Nominal:	Tol. min.:	Tol. max.:
<b>A</b>	25.4	-0.51	+ 0.51
<b>B</b>	15.9 Ref.		
<b>C</b>	6.35	-0.12	+ 0.12
<b>D</b>	9.27 Min.		
<b>E</b>	12.7 Ref.		
<b>L</b>	6.45	-0.15	+ 0.15
Eff. Parameters			
Ae mm <sup>2</sup>	Amin mm <sup>2</sup>	le mm	Ve mm <sup>3</sup>
40.4	40.4	83.4	3370

**INDUCTANCE**

**MARKING**

AL value (nH/T <sup>2</sup> )	Test conditions	R UC
Nom: 1107 Min.: 830	10 kHz, < 0.5 mT, 25 °C	

**CORE LOSSES**

P <sub>i</sub> max	Test conditions
89 mW/cm <sup>3</sup> (0.3 W/set)	100 kHz, 100 mT, 100 °C
593 mW/cm <sup>3</sup> (2 W/set)	100 kHz, 200 mT, 100 °C

**NOTE**

Spec. modifications	Previous	Revised
2005-06-22	L=6.35 +0/-0.12 Losses: General R material	L=6.45±0.15 Losses: Detail as indicated