

**DIMENSIONS**

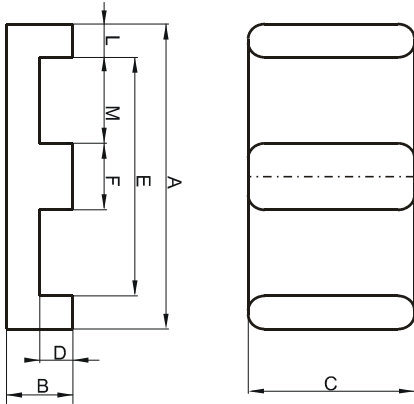

(mm)	Nominal:	Tol. min.:	Tol. max.:
<b>A</b>	21.8	-0.4	+ 0.4
<b>B</b>	5.7	-0.1	+ 0.1
<b>C</b>	15.8	-0.3	+ 0.3
<b>D</b>	3.2	-0.1	+ 0.1
<b>E</b>	16.8	-0.4	+ 0.4
<b>F</b>	5.0	-0.1	+ 0.1
<b>L</b>	2.6 Ref.		
<b>M</b>	5.9 Ref.		
<b>Eff. Parameters</b>			
<b>Ae mm<sup>2</sup></b>	<b>Amin mm<sup>2</sup></b>	<b>le mm</b>	<b>Ve mm<sup>3</sup></b>
78.3	77.9	32.5	2540

**INDUCTANCE**

<b>AL value (nH/T<sup>2</sup>)</b>	<b>Test conditions</b>
4600 ± 25%	10 kHz, < 0.5 mT, 25 °C

**MARKING**

0R42214EC

**CORE LOSSES**

<b>P<sub>i</sub> max</b>	<b>Test conditions</b>
< 0.22 W/set (< 87 mW/cm <sup>3</sup> )	100 kHz, 100 mT, 100 °C
< 1.55 W/set (< 612 mW/cm <sup>3</sup> )	100 kHz, 200 mT, 100 °C

**NOTE**

<b>Spec. modifications</b>	<b>Previous</b>	<b>Revised</b>
2014-04-23		Issued