

Specification for:

0R41515EC

110 Delta Drive
Pittsburgh, PA 15238
Phone: 412/696-1333
Fax: 412/696-0333
Email: magnetics@spang.com

DIMENSIONS

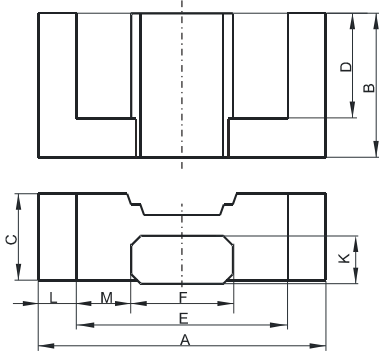

(mm)	Nominal:	Tol. min.:	Tol. max.:
A	15.0	-0.4	+ 0.4
B	7.5	-0.15	+ 0.15
C	4.65	-0.15	+ 0.15
D	5.5	-0.25	+ 0.25
E	11.0	-0.35	+ 0.35
F	5.3	-0.15	+ 0.15
K	2.4	-0.1	+ 0.1
L	2.0 Nom.		
M	2.85 Nom.		
Eff. Parameters			
Ae mm²	Amin mm²	le mm	Ve mm³
15.0	12.2	34.0	510

INDUCTANCE

AL value (nH)	Test conditions
Nom: 893 Min.: 670	10 kHz, < 0.5 mT, 25 °C

MARKING

No marking

CORE LOSSES

P_i max	Test conditions
88 mW/cm ³ (0.045 W/set)	100 kHz, 100 mT, 100 °C
549 mW/cm ³ (28 W/set)	100 kHz, 200 mT, 100 °C

NOTE

Spec. modifications	Previous	Revised
2005-06-16	A=15.5±0.4 D=5.3 Min. Losses: General R material	A=15.0±0.4 D=5.25 Min. Losses: Detail as indicated