

DIMENSIONS

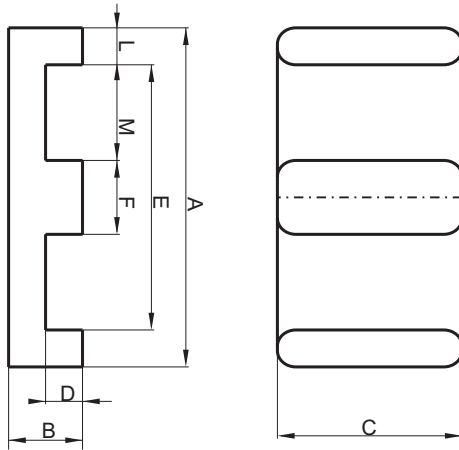

(mm)	Nominal:	Tol.min.:	Tol.max.:
(A)	14.0	-0.3	+0.3
(B)	2.5	-0.1	+0.1
(C)	5.0	-0.1	+0.1
(D)	1.0	-0.1	+0.1
(E)	11.0	-0.25	+0.25
(F)	3.0	-0.1	+0.1
(L)	1.5	---	---
(M)	4.0	---	---
Eff. Parameters			
A_e mm²	A_{min} mm²	l_e mm	V_e mm³
14.7	14.7	16.7	244

INDUCTANCE

AI value (nH)	Test conditions
Nominal: 1653 Minimum: 1240	10 kHz, 0.5 mT, 25°C

CORE LOSSES

P_i max	Test conditions
86 mW/cm ³ (0.021 W/set) 615 mW/cm ³ (0.15 W/set)	100 kHz, 100 mT, 100°C 100 kHz, 200 mT, 100°C

MARKING

No marking

NOTE

Spec. modification	Previous	Revised
2005.06.16	LOSSES: GENERAL R MATERIAL	LOSSES: DETAIL AS INDICATED