



Specification for:

0R41106UC

110 Delta Drive
 Pittsburgh, PA 15238
 Phone: 412/696-1333
 Fax: 412/696-0333
 Email: magnetics@spang.com

DIMENSIONS

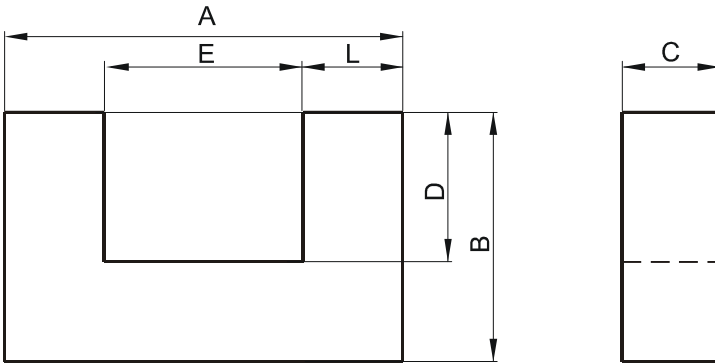

(mm)	Nominal:	Tol. min.:	Tol. max.:
A	10.85	-0.2	+ 0.2
B	4.19	-0.13	+ 0.13
C	6.3	-0.13	+ 0.13
D	2.24	-0.13	+ 0.13
E	7.19	-0.2	+ 0.2
L	1.83	-0.13	+ 0.13
Eff. Parameters			
Ae mm²	Amin mm²	le mm	Ve mm³
12.0	11.5	29.2	350

INDUCTANCE

AL value (nH)	Test conditions
Nom: 1027 Min.: 770	10 kHz, < 0.5 mT, 25 °C

MARKING

No marking

CORE LOSSES

P _i max	Test conditions
91 mW/cm ³ (0.032 W/set)	100 kHz, 100 mT, 100 °C
571 mW/cm ³ (0.2 W/set)	100 kHz, 200 mT, 100 °C

NOTE

Spec. modifications	Previous	Revised
2005-06-22	A=10.8±0.2 Losses: General R material	A=10.85±0.2 Losses: Detail as indicated