

DIMENSIONS

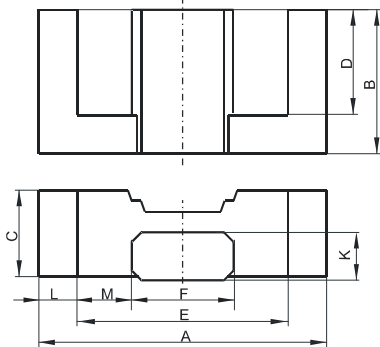

(mm)	Nominal:	Tol. min.:	Tol. max.:
A	10.5	-0.3	+ 0.3
B	5.2	-0.1	+ 0.1
C	2.7	-0.1	+ 0.1
D	3.75	-0.15	+ 0.15
E	7.65	-0.25	+ 0.25
F	4.55	-0.15	+ 0.15
K	1.45	-0.05	+ 0.05
L	1.43 Ref.		
M	1.55 Ref.		
Eff. Parameters			
Ae mm²	Amin mm²	le mm	Ve mm³
7.2	6.5	23.7	171

INDUCTANCE

MARKING

AL value (nH/T²)	Test conditions	No marking
Nom: 585 Min.: 438	10 kHz, < 0.5 mT, 25 °C	

CORE LOSSES

P_i max	Test conditions
< 0.016 W/set (< 94 mW/cm ³)	100 kHz, 100 mT, 100 °C
< 0.09 W/set (< 500 mW/cm ³)	100 kHz, 200 mT, 100 °C