

DIMENSIONS

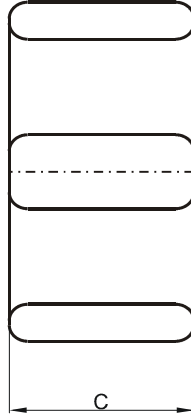
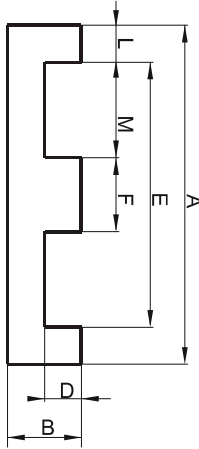

(mm)	Nominal:	Tol. min.:	Tol. max.:
A	43.2	-0.5	+ 0.5
B	8.51	-0.25	+ 0.25
C	27.94	-0.38	+ 0.38
D	4.19 Min.		
E	34.4 Min.		
F	8.13	-0.13	+ 0.13
L	4.2 Nom.		
M	13.46 Nom.		
Eff. Parameters			
Ae mm ²	Amin mm ²	le mm	Ve mm ³
227	227	57.5	13100

INDUCTANCE

MARKING

AL value (nH/T ²)	Test conditions	
Nom: 9150 Min.: 6863	10 kHz, < 0.5 mT, 25 °C	0P44308EC PXXXXX

CORE LOSSES

P _i max	Test conditions
130 mW/cm ³ (1.7 W/set)	100 kHz, 100 mT, 100 °C

NOTE

Spec. modifications	Previous	Revised
2005-06-01	Flat tooling resulting in sharp corners AL=6982 Min. L=4.06±0.13 Losses: General P material	Multilevel tooling resulting in radius corners AL=6863 Min. L=4.2 Nom. Losses: Detail as indicated